

# YN35mm F2 User Manual

**Thanks for choosing YONGNUO product!**  
Please read this user manual carefully before use and understand this manual for proper use. Keep this manual properly for reference in the future.

**⚠ Safety Precautions**  
✖ Don't view the sun or bright light through the lens or the camera. If not, the vision will be impaired. Viewing the sun through the lens is particularly harmful.  
✖ Don't place the lens without a lens cover under the sun, no matter whether the lens set on the camera or not. If not, the lens may gather light and cause a fire.

**🔧 Maintenance and Storage**  
✖ Keep this product from striking and avoid placing this product in an extremely hot, extremely cold or humid environment.  
✖ For long-term storage, it's appropriate to store this product in a dry cold and well-ventilated place. To protect blooming layer of the lens, it's recommended to keep this product away from inset pill or place pervades the smell the inset pill flings off.  
✖ The dirt and fingerprint on the lens should be cleaned with soft and moist lens cleaning cloth or lens cleaning tissue; do not clean the lens with solvent, benzene or other organic cleansers.  
✖ This product is not waterproof. Please be careful when you use it in a raining day or nearby water and be sure not to get it wet. If the internal parts, the lens or the electronic components are damaged for this product gets wet, it's quite possibly that this product won't be repaired any longer.  
✖ Water vapor or water drop may condense on the surface of the lens for temperature jump. Therefore, when the lens is carried into a warm indoor environment from the cold outdoors, it's best to put the lens into a sealed plastic bag till the lens temperature is closed to room temperature. (Vice versa).

## I. Nomenclature

- ①Focus Mode switch
- ②Lens mounting index
- ③Electronic contact
- ④Focusing ring

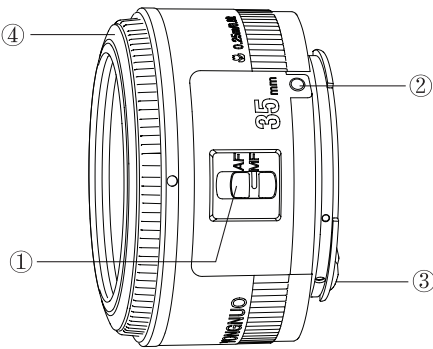

## II. Lens Mount (Dismount)

Align the red mounting sign on the lens to the red lens mounting sign on the camera, and then rotate the lens clockwise till it clicks. To dismount the lens, rotate it anti-clockwise till it stalls. (For more details about mounting/dismounting lens, please refer to the camera user manual.)

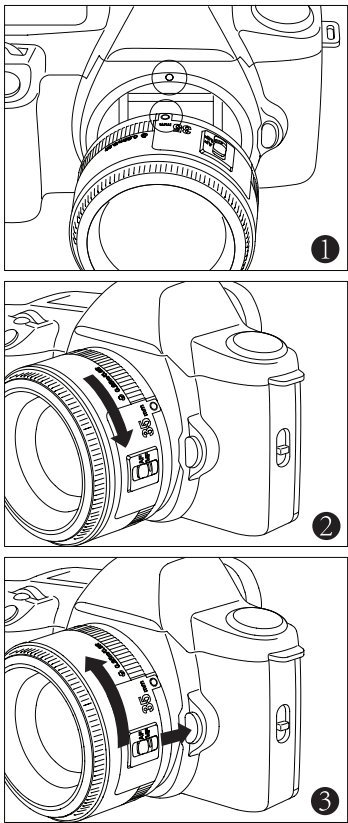

- After the lens is dismounted, please place the back of the lens upwards to keep the surface of the lens and the electronic contact from getting scratched.
- If the electronic contact gets dirty, scratched or fingerprinted, it may lead to corrosion or bad contact.

Camera or lens may not work normally. If the electronic contact gets dirty or fingerprinted, please wipe and clean it with soft cloth.  
● When dismounting the lens, please make a dust cover fit on. To mount the dust cover correctly, align the mounting sign on the dust cover to the red mounting sign on the lens, and then rotate it clockwise. To dismount the dust cover, rotate it anti-clockwise.

## III. Setting Focus Mode

In order to shoot in Auto Focus (AF) mode, please set the focus mode switch as AF. In order to shoot in Manual Focus (MF) mode, please set the focus mode switch as MF, and rotate the focusing ring to focus.  
● When AF (Auto Focus) function is enabled, please do not touch the rotating part of the lens.  
● When the focus mode is set as AF (Auto Focus) mode, please do not manually focus (MF).

## IV. Filter Lens (Optional)

A 52mm filter lens can be set on the filter mounting thread in the front end of the lens. Different filter lenses will create different effects in photographing.

## V. Specification

View-angle Coverage	Diagonal	63°
	Vertical	38°
	Horizontal	54°
Lens Structure		5sets;7 pieces
Aperture Blade		7 pieces
Minimum Aperture		f/22
Minimum Focusing Distance		0.25m/0.8ft
Maximum Magnification		0.23×
Filter Diameter/ QuantityAvailable		52mm/1
Maximum Diameter & Length		About 73×59mm
Weight		About 155g

- Lens length refers to distance from fitting surface to the front end of the lens.
- Unless otherwise stated, the size and weight are suitable for lens only.
- Aperture setting can be assigned by the camera.

The latest electronic version of this manual can be got on <http://www.hkyongnuo.com>.  
The functions and data in this manual are acquired based on test conditions of our company. Further notice will not be given if the design and specification change.  
The YONGNUO logo in this manual includes the registered trademark or trademark of SHENZHEN YONGNUO PHOTOGRAPHY EQUIPMENT CO., Ltd in China or/and other countries (regions). All other trademark are the property of this respective owner.