

# YN100mm F2

## User Manual

### Thanks for choosing YONGNUO product!

Please read this user manual carefully before use and understand this manual for proper use. Keep this manual properly for reference in the future. There is a protective film in each side of the lens when leaving the factory. Please tear them before use, otherwise it will influence the imaging resolution.

### ⚠ Safety Precautions

- Do not stare at the sun or a bright light source through the lens or camera. Otherwise it could result in visual impairment.
- Whether the lens installed on the camera or not, do not place the lens which without lens cover in the sun. Otherwise the lens may gather light and result in a fire.

### 🔧 Maintenance and Saving Precautions

- Should avoid collisions or placed directly in extreme heat, cold or wet environment.
- For long-term storage, please select the cool, dry and ventilated place. In order to protect the film of lens, it is suggested that far from the insect-resistant pill or insect pill emit gases.
- Contaminant or fingerprint on the lens can be cleaned with slight damp soft cleaning cloth or lens paper, do not use solvents, benzene or other organic cleaner.
- The lens is not waterproof, rain or close to the water must be especially careful when using, do not get wet. If the internal parts, lens and electronic components was damaged due to wet, it may cause unlikely to repair.
- Temperature mutations could make the surface of the lens condense to fog or water droplets, so when the weather was cold into a warm indoor environment, it is suggested to place the lens into the sealed plastic bag, until the lens temperature close to room temperature. When the lens from the heat to the cold environment, also please use the same method.

## I .Nomenclature

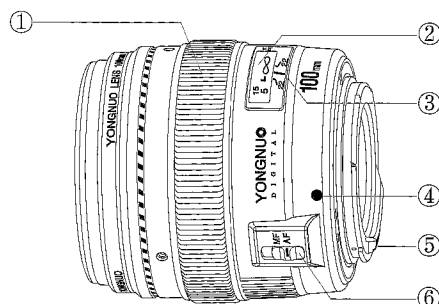

- ①Focus ring
- ②Focus range indicator
- ③Focus distance markers
- ④Lens mounting mark
- ⑤Electronic contact
- ⑥Focus modes switch

## II .Install and Discharge the Lens

Install the lens with the white mounting mark direct at the red lens mounting mark of the camera, then rotate the lens in clockwise direction until hearing the sound of "click". If you want to discharge the lens, rotate the lens in counterclockwise direction until it stop running. (For the detailed steps of lens installation and discharge please refer to the camera instruction manual).

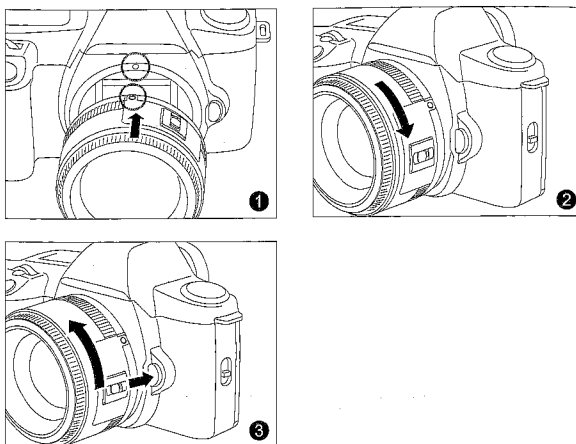

- After discharging the lens, please place the lens back-end upwards in order to avoid scratch the lens surface and electronic contact.
- If the electronic contact is smeared, scratched, or stained with fingerprint, may cause corrosion or poor contact. The camera and lens might not work properly. Please use soft cloth to wipe it if the electronic contact is smeared or stained with fingerprint.
- When taking off the lens, please install the dust cover. To properly install the dust cover, allow the mounting mark on the dust cover direct at the red mounting mark of the lens, and rotate in clockwise direction. While rotate in counterclockwise direction to take down the dust cover.

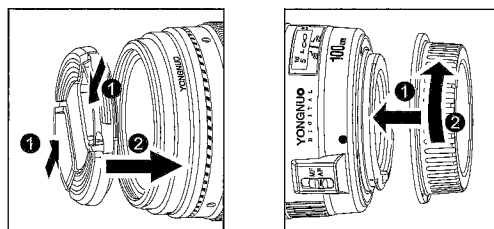

## III .Focus Mode Setting

To use the auto-focus (AF) mode in shooting, please set the focus mode to AF. To use the manual focus (MF) mode in shooting, please set the mode to MF, then rotate the focusing ring to focus.

- When enable the AF (auto focus) function, please do not touch the rotating parts of the lens.

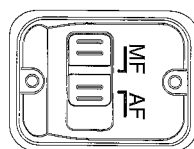

## IV .Lens Hood

If necessary, you can purchase a lens hood to protect the lens and resist the scattered beam which may generate stray lights or ghosting.

- Canon hood ET-65III can be used on YN100mm F2.
- Part of the picture may be blocked if the hood is not attached properly.

## V .Troubleshoot

**1. In spite it has been adjusted to most clear by manual focus, the image is still vague.**

There is a protective film in each side of the lens when leaving the factory. Please tear them before use; besides, please check if the contaminant or fingerprint on the both sides of the lens, if exist please clean with slight damp soft lens cloth or lens paper.

**2. Always lose focus when using Auto focus to take photos.**

Parts of the high-end camera supports fine tuning function. Please enter into the function and make sure the focus fine-tuning value is set to 0, for the detail setting method, please refer to your camera manual.

**3. Abnormal communication when the lens installed on the camera.**

Please make sure the lens in proper installation and the electric contacts of the lens and camera are without foreign body.

**4. The lens has set to auto focus (AF), but unable to focus when half pressing the camera shutter.**

If your camera with the focus mode switch, please make sure the camera focus mode switch is set to auto focus (AF).

## VI .Product Specification

The Lens Focal Length	100mm
Lens Construction	6 sets; 8 pieces
Aperture Blades	9 pieces
Minimum Aperture	F/22
Minimum Focusing Distance	About 0.9 meters
Maximum Magnification	About 0.14 times
Drive Dystem	Direct current motor
Filter Diameter	58mm
Maximum Diameter and Length	About Φ76×83mm
Weight	About 390g

- The lens length refers to the distance from the mounting side to the lens front end.
- Unless special stated, the dimension and weight is only suitable for lens.
- The Aperture can be specified by the camera.

The latest version of this user manual can be acquired from [www.hkyongnuo.com](http://www.hkyongnuo.com).

The functions and data of this manual are based on test conditions of our company. If any changes in the design and specifications will without notice.

The YONGNUO logo in this manual is the trademark of SHENZHEN YONGNUO PHOTOGRAPHY EQUIPMENT Co., Ltd and registered trademark in China or/and other countries (regions). All other trademarks are the property of their respective owners.

Shenzhen Yong Nuo Photographic Equipment Co., Ltd  
Address : 2-B509 Saige Science & Technology Park, North Huaqian Rd, Futian District, Shenzhen, China  
TEL: (086) 0755-8376 2448

Email: [service@hkyongnuo.com](mailto:service@hkyongnuo.com)  
Website: [www.hkyongnuo.com](http://www.hkyongnuo.com)